

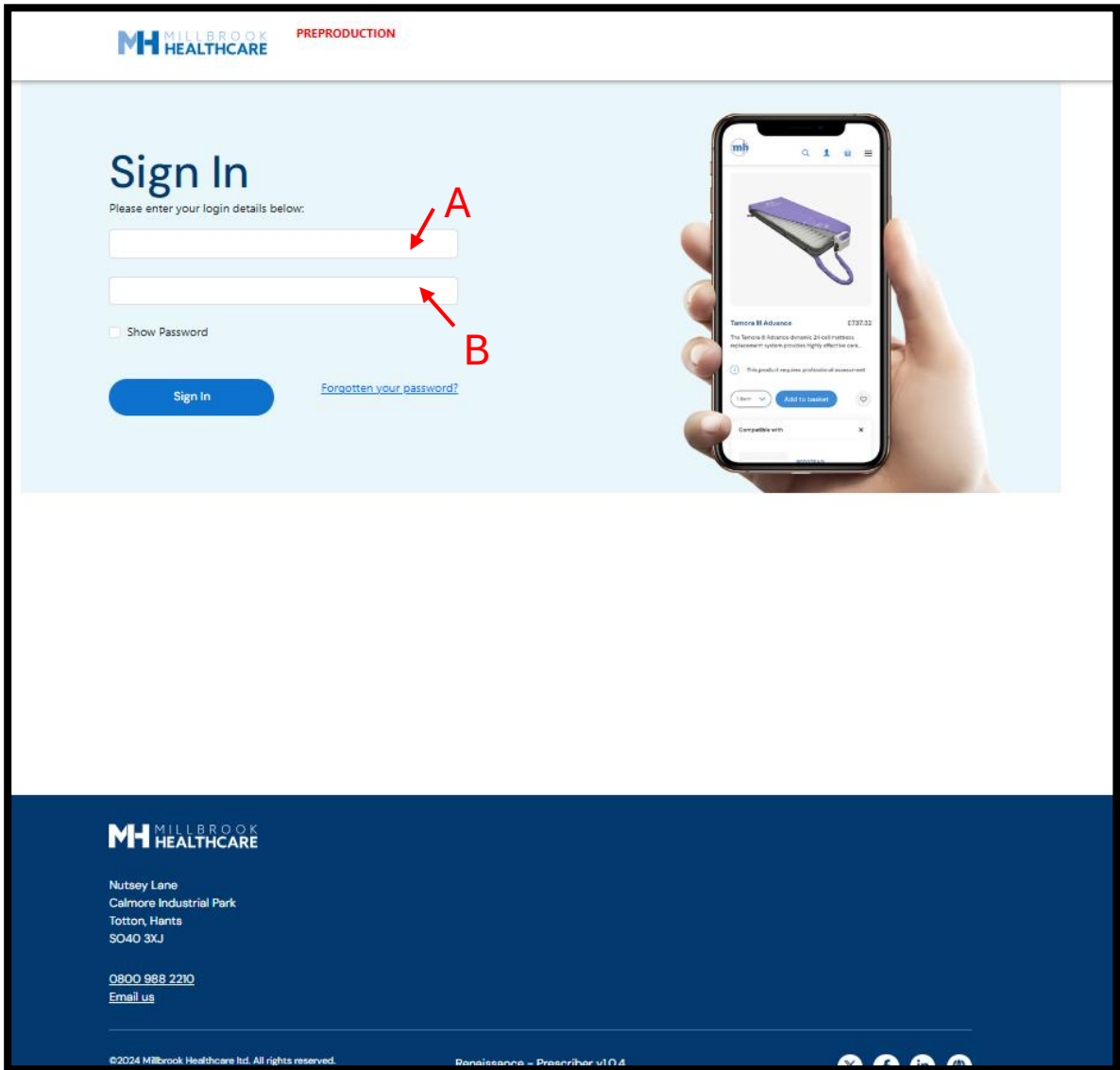

MILLFLOW Prescriber Portal Guide

Locating the Millflow
'HOW TO' guides

The Login page



Notes

A – Input your PIN in this field

B – Input you Password in this field

The Login page

Notes

Millflow now displays the page below.

C. Millflow is requesting you input a 6-digit verification code which has been sent to your email

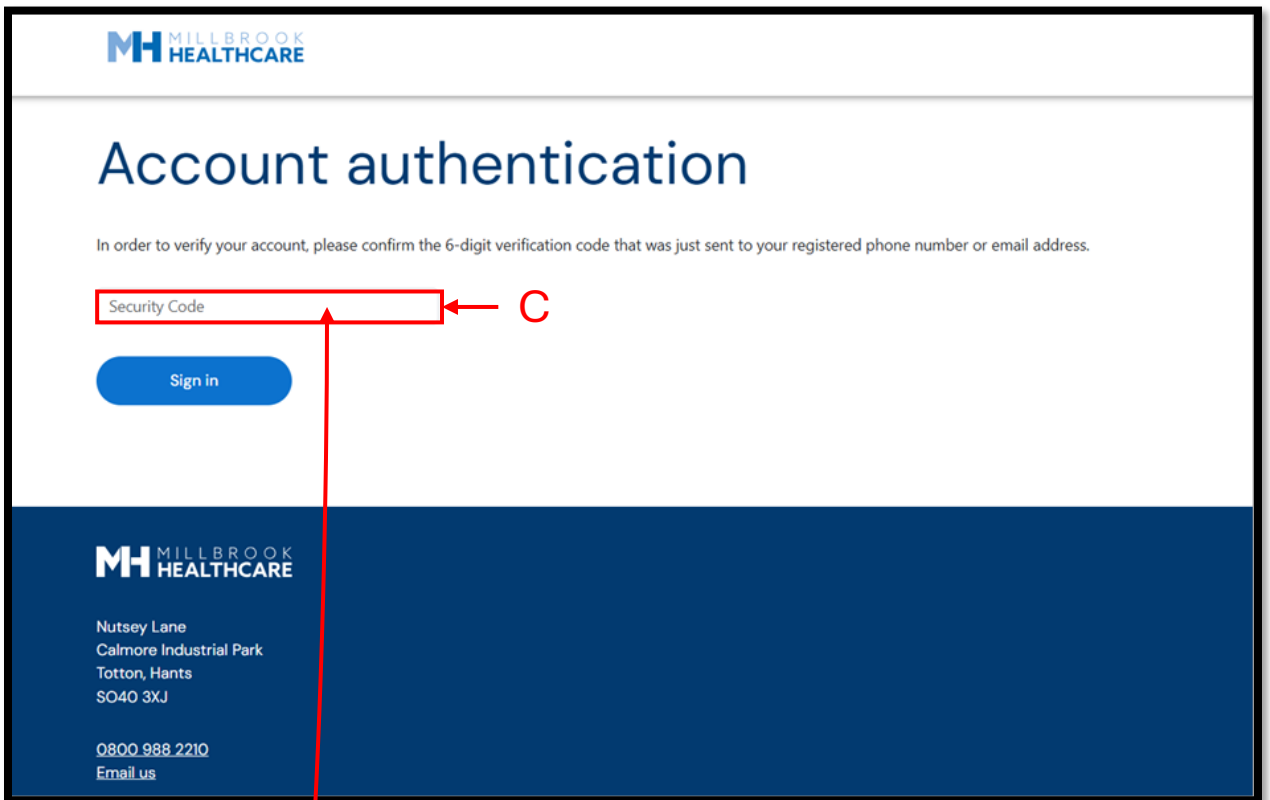

The screenshot shows the 'Account authentication' page for Millbrook Healthcare. At the top left is the logo 'MH MILLBROOK HEALTHCARE'. The main heading is 'Account authentication'. Below this, a message reads: 'In order to verify your account, please confirm the 6-digit verification code that was just sent to your registered phone number or email address.' There is a text input field labeled 'Security Code' with a red box around it and a red arrow pointing to it from the letter 'C'. Below the input field is a blue 'Sign in' button. At the bottom of the page, there is contact information: 'MH MILLBROOK HEALTHCARE', 'Nutsey Lane, Calmore Industrial Park, Totton, Hants, SO40 3XJ', '0800 988 2210', and 'Email us'.

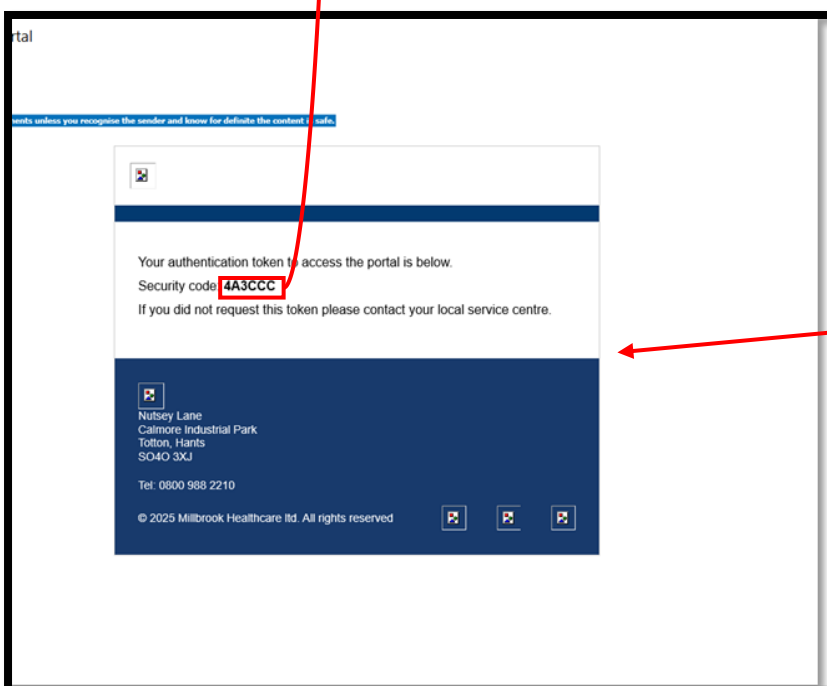

Notes

On checking your email you will find a message from MILLBROOK HEALTHCARE with the authentication code detailed

The Landing page

A

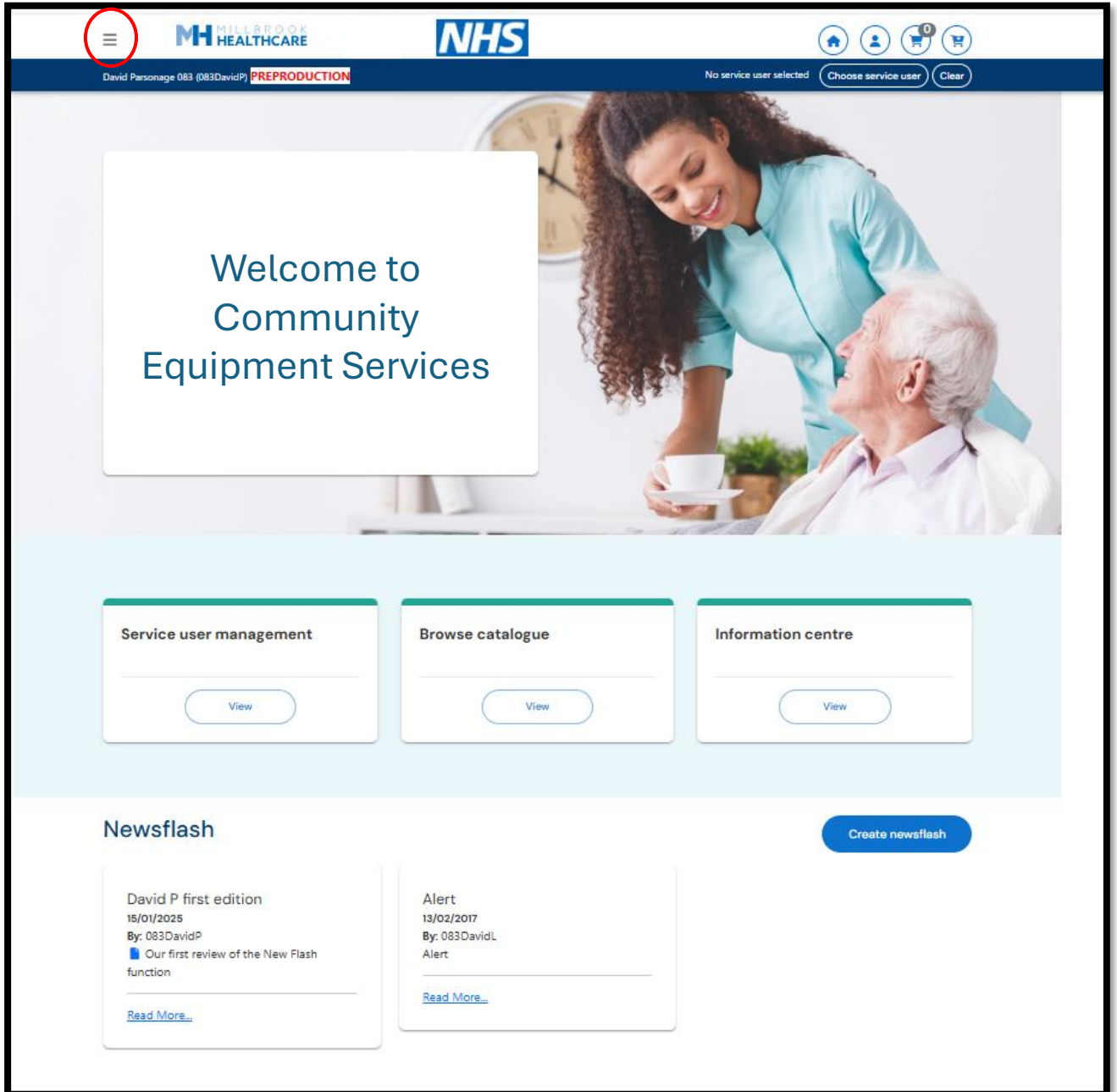

Notes

A – Click on the BURGER MENU

The Landing page

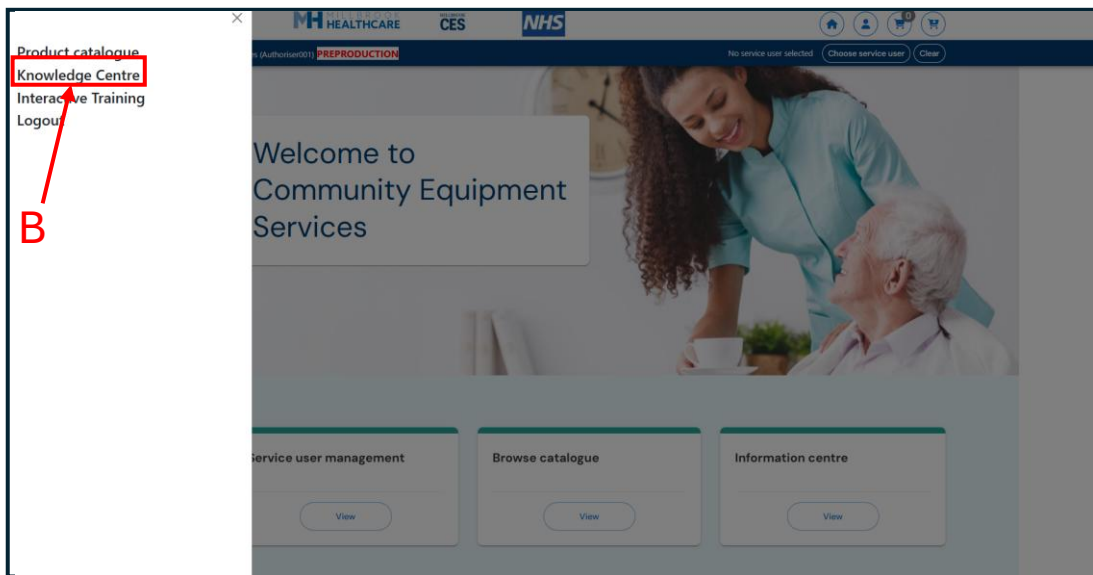

Notes

B – Click on KNOWLEDGE CENTRE

The knowledge centre

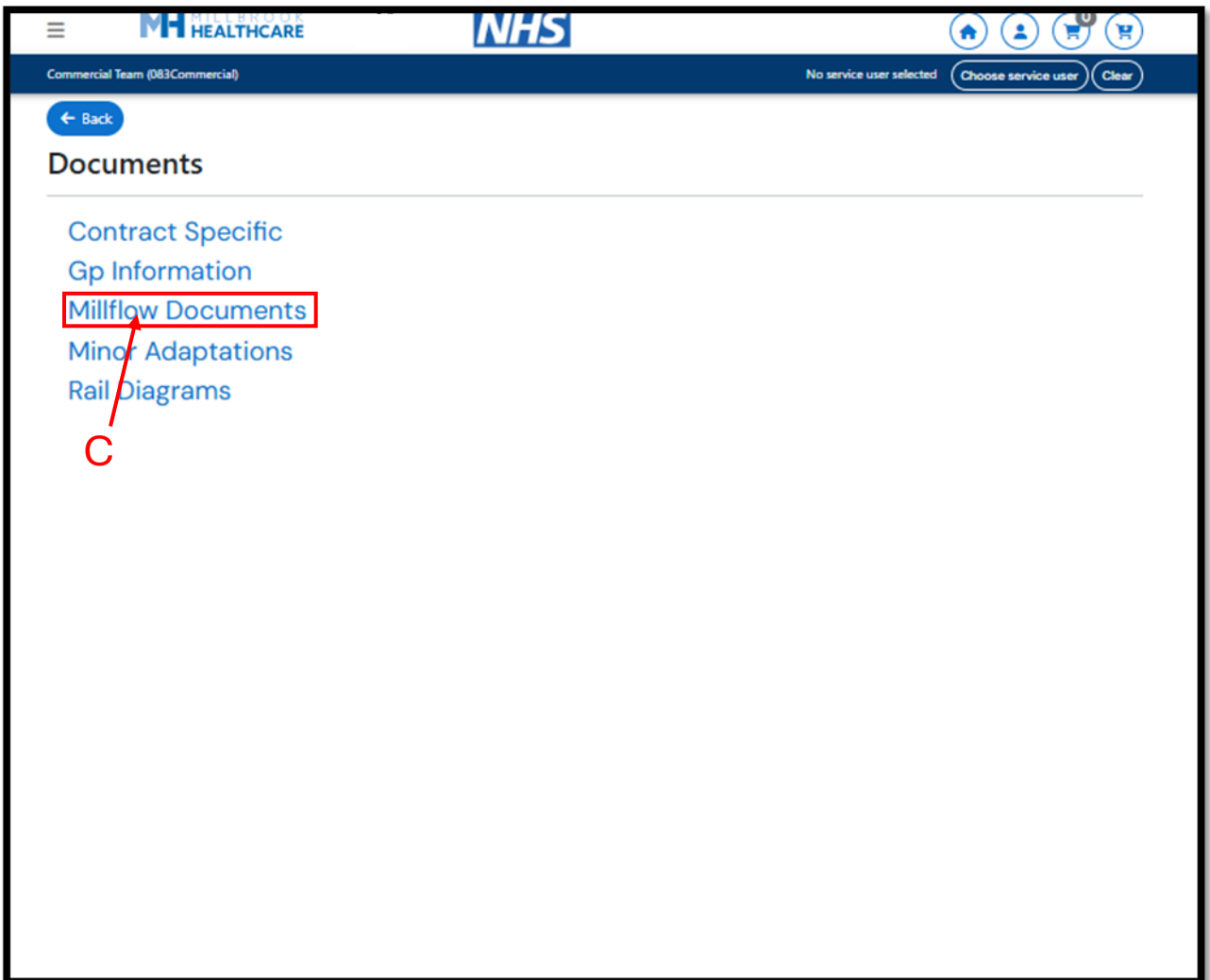

Notes

C – Click on MILLFLOW DOCUMENTS

Millflow Documents

The screenshot shows the NHS Millflow Documents page. At the top, there are logos for Millbrook Healthcare and NHS, along with navigation icons and a user selection area. The main content area is titled 'Documents' and lists several categories: Contract Specific, Gp Information, Millflow Documents (highlighted with a red box and labeled 'D'), Minor Adaptations, and Rail Diagrams. Below this, a table displays a list of documents under the 'Millflow Documents' category. The table has columns for 'Description', 'File Type', and 'Download'. Each document has a corresponding '.pdf' file type and a 'Download' button. A red box labeled 'E' encompasses the entire table. At the bottom of the table, there are navigation buttons for 'First', 'Previous', 'Next', and 'Last', and a page indicator 'Page 1 of 2'.

Category	Sub Category	Description	File Type	Download
Millflow Documents	Millflow Documents	Adding Pre-contract equipment	.pdf	Download
		Changing your Password	.pdf	Download
		Client Information - Adding a New Client	.pdf	Download
		Client Information - Adding additional address	.pdf	Download
		Client Information - Editing an existing Client	.pdf	Download
		Client Information - Locating a Client	.pdf	Download
		Introduction to Millflow	.pdf	Download
		Order tracking	.pdf	Download
		Peripheral store issue to Client	.pdf	Download
		Raising a Collection order for a client	.pdf	Download

Notes

D – Click on the MILLFLOW DOCUMENTS that appears under the original
E – All the 'How to' guides are detailed & available for download