



MILLFLOW

Prescriber Portal Guide

Logging in
&
The landing page

The Login page

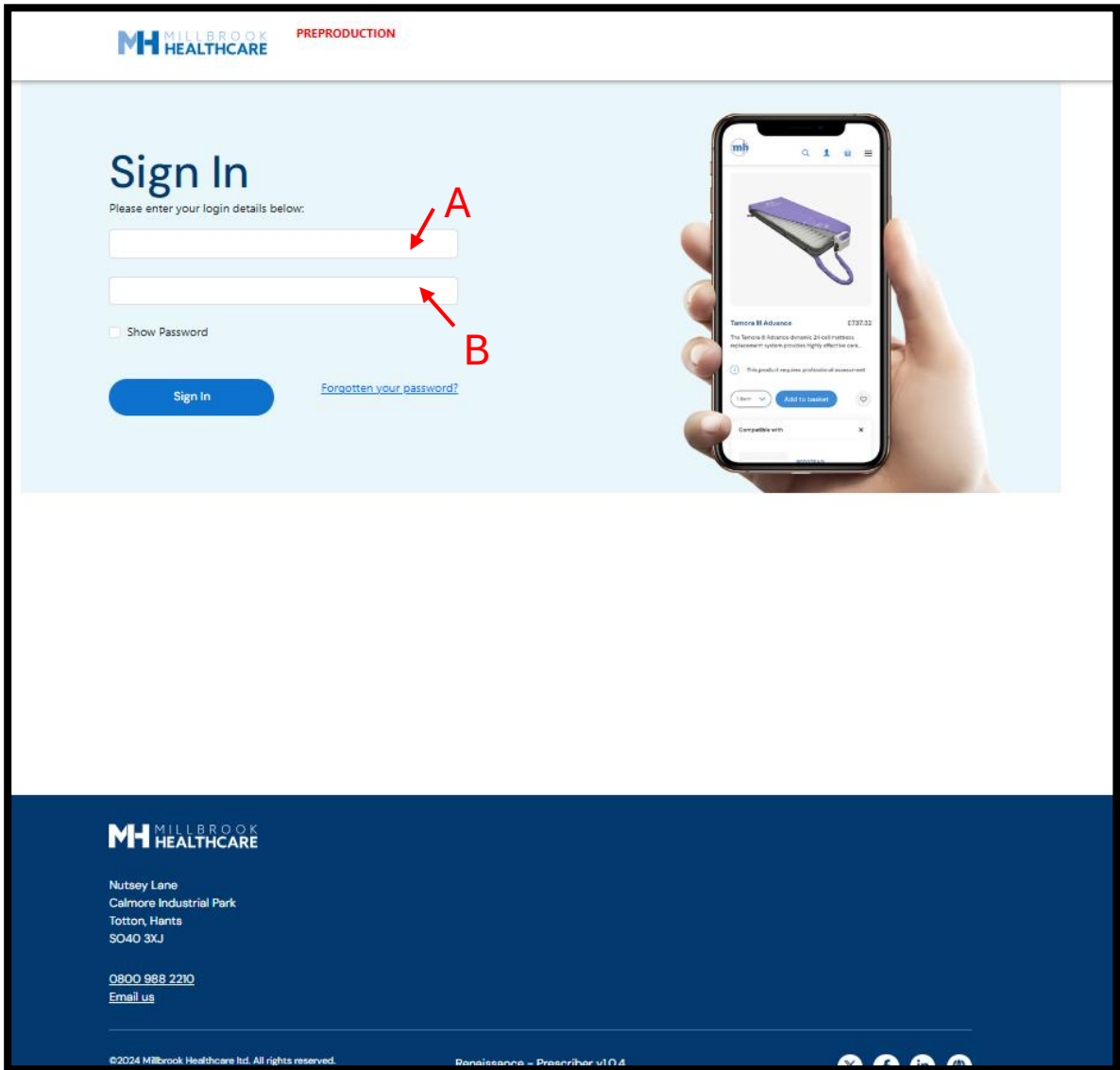

Notes

A – Input your PIN in this field

B – Input you Password in this field

The Login page

Notes

Millflow now displays the page below.

C. Millflow is requesting you input a 6-digit verification code which has been sent to your email

The screenshot shows the 'Account authentication' page for Millbrook Healthcare. At the top left is the logo 'MH MILLBROOK HEALTHCARE'. The main heading is 'Account authentication'. Below this, a message reads: 'In order to verify your account, please confirm the 6-digit verification code that was just sent to your registered phone number or email address.' There is a text input field labeled 'Security Code' with a red box around it and a red arrow pointing to it from the letter 'C'. Below the input field is a blue 'Sign in' button. At the bottom of the page, there is contact information: 'MH MILLBROOK HEALTHCARE', 'Nutsey Lane, Calmore Industrial Park, Totton, Hants, SO40 3XJ', '0800 988 2210', and 'Email us'.

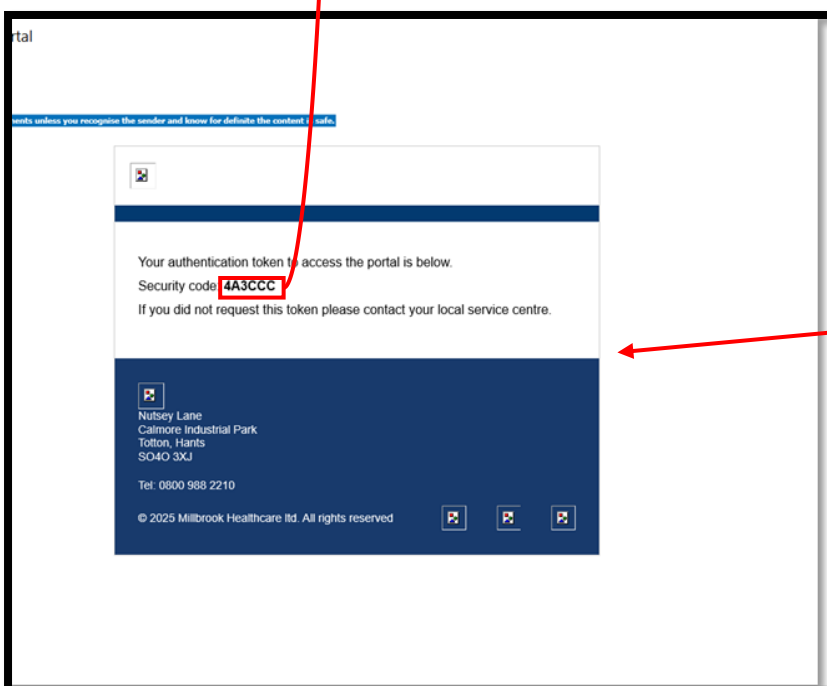

Notes

On checking your email you will find a message from MILLBROOK HEALTHCARE with the authentication code detailed

The Landing page

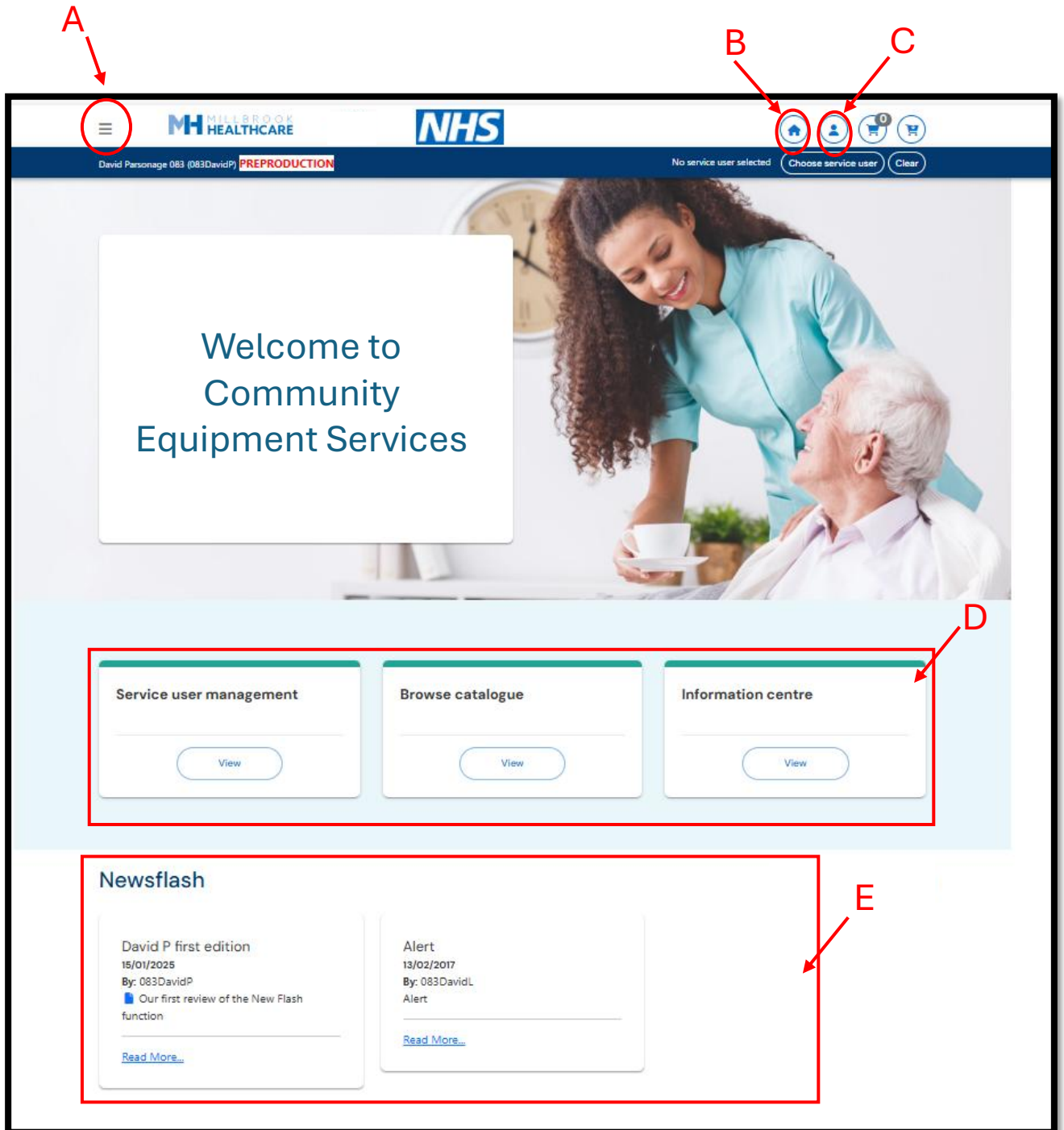

Notes

A – The Burger Menu – See page 4 for more information

B – The HOME ICON will always take you back to your home screen

C – Quick Navigation ICON – See page 5 for more information

D - Three main tiles to take you to

- Your patients or service users
- The Standard Equipment catalogue
- Information Centre to authorise track orders and see your account information.

E - All Newsflashes appear here. Allowing you to stay in touch with latest updates from your colleagues and the contract management team

The Burger Menu

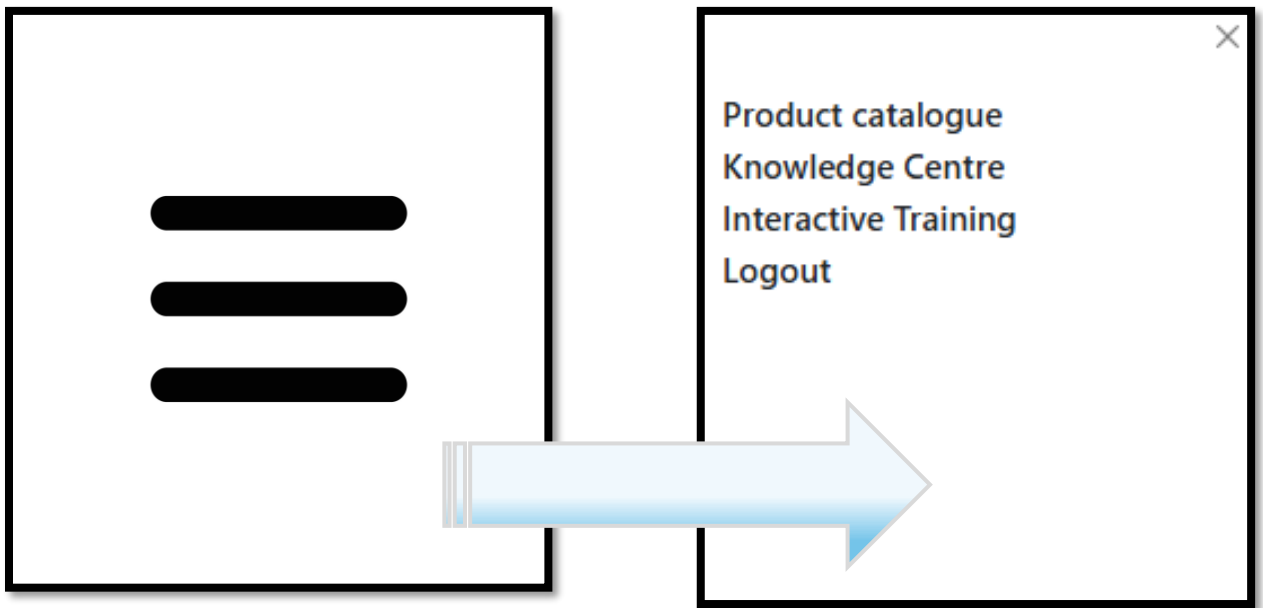

Notes

Clicking on the Burger Menu will open a menu of shortcut options on the left of the screen. The options listed are

Product Catalogue – Takes you to the equipment catalogue. You can view the Standard equipment catalogue, Recycled Specials, your most ordered items or recently ordered items

Knowledge Centre – Here you can access Rail installation templates, Equipment forms & Policies & other useful information

Interactive training – training videos to support the use of Millflow

Logout – Will log you out of Millflow

Quick Navigation ICON

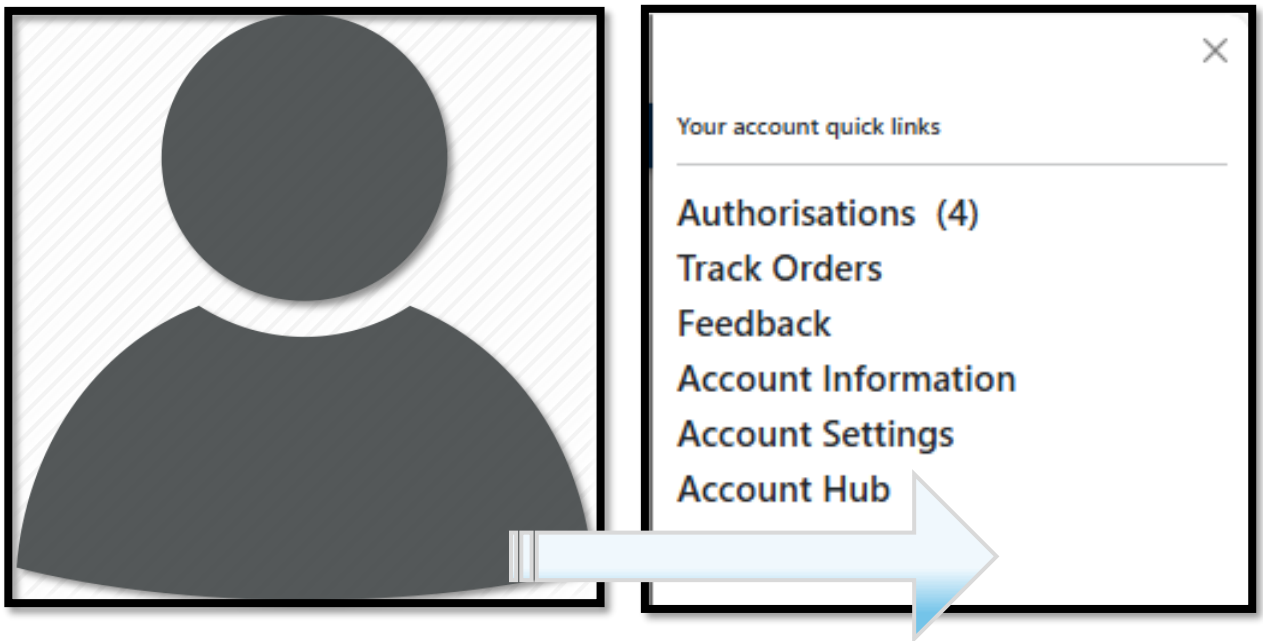

Notes

Clicking on the Quick Navigation Icon will open a menu of shortcut options on the right of the screen. The options listed are

Authorisations – Takes you to orders waiting for your authorisation

Track Orders – Here you can track, your own orders, orders by Service user, orders by prescriber, orders by order number or requisition number

Feedback – Here you can review status of service feedback events you have raised, or you can raise service feedback that is not linked to a specific service user or activity

Account information – Here you can review the authority levels of your PIN. You can check which activity speeds are available for your PIN, you can review what equipment items are available for your PIN and what spend limits apply to your PIN for a Basket of equipment items, an individual equipment item or special equipment items